



BLOOMFIELD

Bloomfield Morris Canal Greenway Goals

- Preserve the right-of-way of the historic canal
- Bloomfield's project should compliment the statewide project
- Connect BMCG to 7 existing municipal/county parks, BOE's fields, and nearby greenways (Lenape, Ice & Rail)
- Connect BMCG to local environmental assets such as Clarks Pond Environmental Center
- Connect BMCG to local historical sites: Town Green, Historic District, Oakeside Mansion/Cultural Center
- BMCG to promote healthy living, recreational activity and township events
- Promote usage by residents, promote visitation from "local" tourists



Morris Canal Features in Bloomfield

- Wrights Field (Tow Path)
- Collins House and Grounds
- Abandoned Section of Canal near GSP Exit 151
- All owned by Bloomfield Twp.

Wrights Field (Morris Canal Tow Path) & Berkley Ave Bridge

- New bridge has elements of old bridge
- Interpretive signage incorporated into project
- Old bridge railings saved and to be repurposed in seating areas on tow path



The Collins House 1980s/1990s

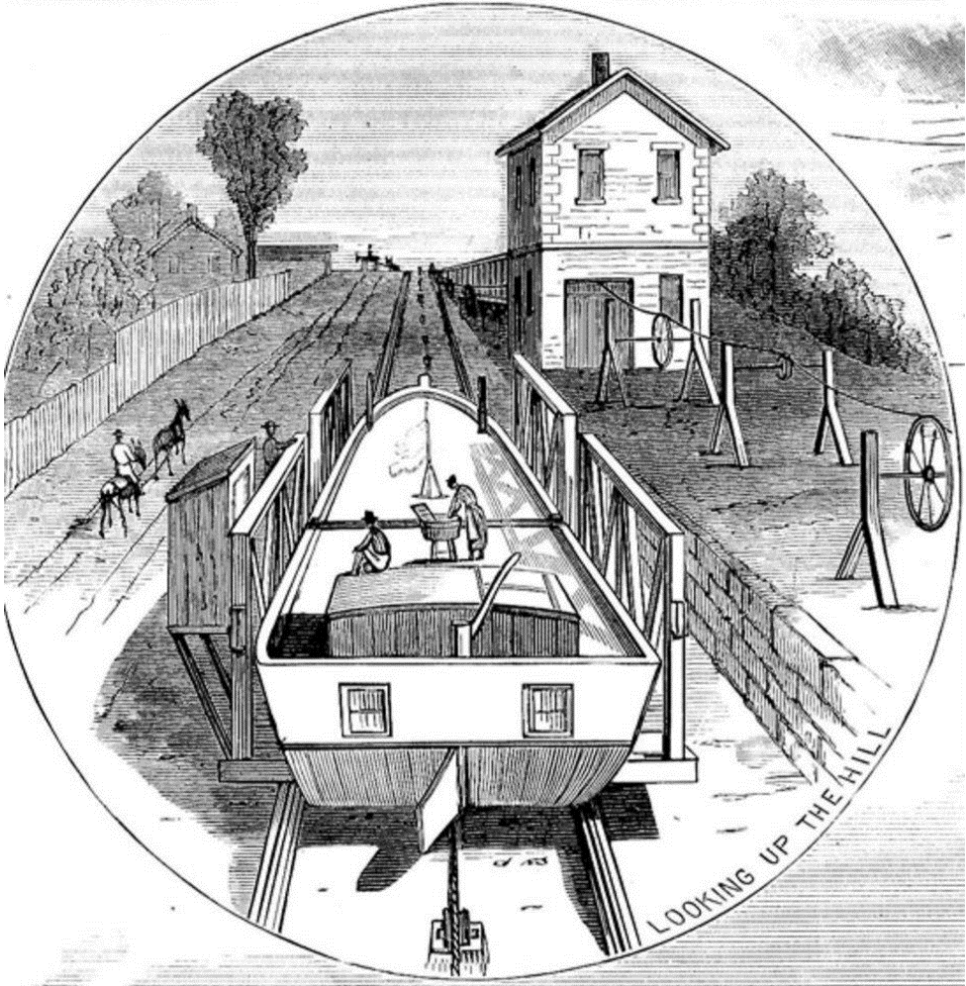

The Collins House 2014



The Collins House – Stabilization #1 2015



The Collins House – Stabilization #1 2015



The Collins House – Adaptive Reuse 2014 Conceptual Drawing

- Community Meeting Space, 1st Floor
- Canal Exhibits
- Exposed areas of House's Inner Architectural Elements
- Caretaker's Apartment, 2nd Floor
- Landscaped Grounds and Gardens as Municipal Park for Passive Recreation

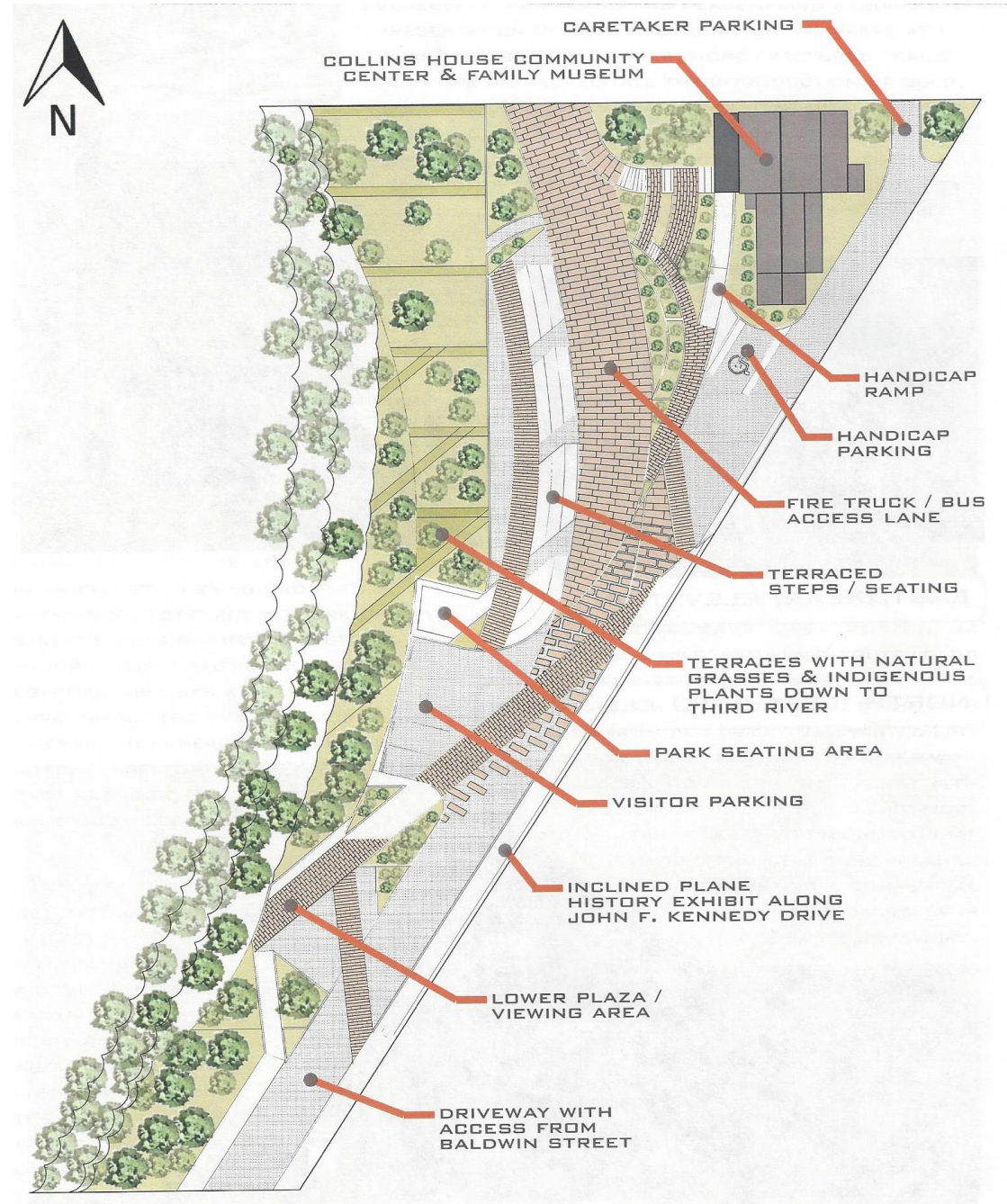

Canal Park at Oak Tree Lane



Section of abandoned Morris Canal 2013, now known as **Canal Park at Oak Tree Lane**



3 Eagle Scout Projects based at Canal Park at Oak Tree Lane



Please Support Connor Heaney's Eagle Project

When: March 25 & 26, 2017
9 am - 3 pm

Where: On the corner of Bessida Street and American Way,
Bloomfield.

What: Clearing a stretch of overgrowth/undergrowth to
become a part of the new Morris Canal Greenway

Please wear work clothes and bring work gloves if you
have them. Lunch & water will be provided.

Please RSVP to Connor:
connortheredhead@gmail.com

Thomas Heaney cell: 973-342-2609



Eagle Scout Project #1 at Canal Park at Oak Tree Lane



Eagle Scout Project #1 at Canal Park at Oak Tree Lane



Canal Park at Oak Tree Lane 2016



Canal Park at Oak Tree Lane 2016

- Has looping trails inside canal's prism
- Encourages rock sculptures by public
- Wildlife nesting boxes installed by Scouts
- Pollinator-friendly planter boxes
- Includes interpretive signage
- Serves as geocaching site



Pollinator-friendly planters at Canal Park at Oak Tree Lane 2016



Dedication of Canal Park at Oak Tree Lane 2016



Dedication of Canal Park at Oak Tree Lane 2016



Signage Sample from Canal Park at Oak Tree Lane 2016

MORRIS CANAL BLOOMFIELD



THE MORRIS CANAL 1831-1924

In 1824 the Morris Canal & Banking Company was chartered to build a canal that would carry coal, mined in Pennsylvania, to developing markets along the eastern seaboard. The canal would pass through the heart of New Jersey's iron district and provide the long-needed transportation system that would create new commercial activity and enable rustic settlements to grow into thriving industrial towns.

When completed in 1831, the canal extended 102 miles across the rugged Highlands of New Jersey, from Phillipsburg on the Delaware River, uphill to its summit level near Lake Hopatcong, and then down to New York Harbor at Jersey City. To accomplish this, a system of 23 locks and 23 inclined planes was built to overcome the impressive elevation change of 1,674 feet.



Morris Canal boats were pulled by mule power. This fully harnessed team has stopped to cut from feed baskets hung over their heads.

The canal's famous water-powered inclined planes were an engineering marvel that enabled canal boats to be raised or lowered up to 100 feet at a time. There was an inclined plane in Bloomfield.

Mule-drawn canal boats, transporting up to 70 tons of cargo, took five days to cross the state. In the heyday of the canal, hundreds of boats carried everything from coal and iron ore to agricultural products. The canal promoted commerce and shaped the economic development of the northern part of the state.

By the early 1900s the canal had become obsolete. However, it took until 1924 to adopt a plan to close and dismantle the canal. The ownership of the canal's vast water resources including Lake Hopatcong, Lake Musconetcong, and Greenwood Lake, passed to the state of New Jersey.

Today, the Morris Canal Greenway, a partnership between local communities like Bloomfield and the Canal Society of New Jersey, seeks to preserve the historic remains of the canal. The Greenway will combine recreation and education by offering trails and bikeways while telling the story of this historic canal.



Above: The 102-mile-long canal climbed uphill through the New Jersey Highlands from Phillipsburg to the summit level near Lake Hopatcong and then descended to New York Harbor at Jersey City.

GREENWAY AT OAK TREE LANE

In 1882 the land around Oak Tree Lane was acquired by German immigrants Michael and Barbara Marzloff. The property was then open farmland extending along the towpath of the Morris Canal with a homestead that may have dated from as far back as the 1840s. Over the years the family sold off parcels that eventually became Pilch, Palmer and Pierson Streets. Marzloff descendants lived in the house until 2004.

Although the building of the Garden State Parkway erased most remains of the canal in this area of Bloomfield, a short section still survives along Oak Tree Lane. From trailheads on Watchung Avenue and Pierson Street, the Oak Tree Lane Greenway Trail allows visitors a rare opportunity to walk along the towpath and through the dry prism of the historic canal.



This turn-of-the-century photo of the canal at Oak Tree Lane in Bloomfield, shows the Marzloff House standing just across the towpath.

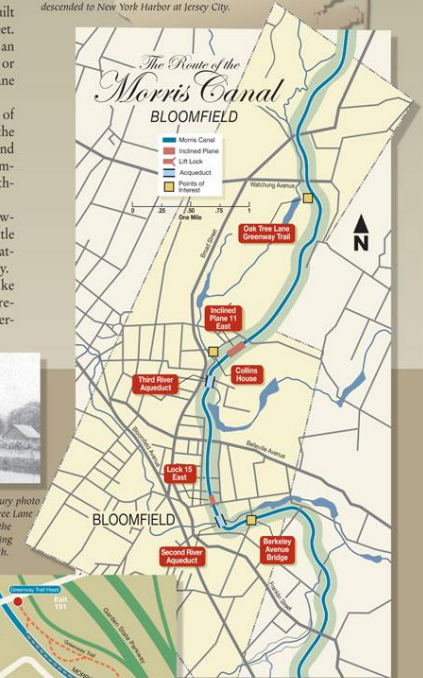

This historic map shows the Morris Canal winding through Bloomfield Township. Along the way canal boats were raised and lowered at Inclined Plane 11 East and Lock 15 East.

Morris Canal Greenway Way Finder Signage, Implementation 2017



Morris Canal Greenway Way Finder Signage, Implementation 2017

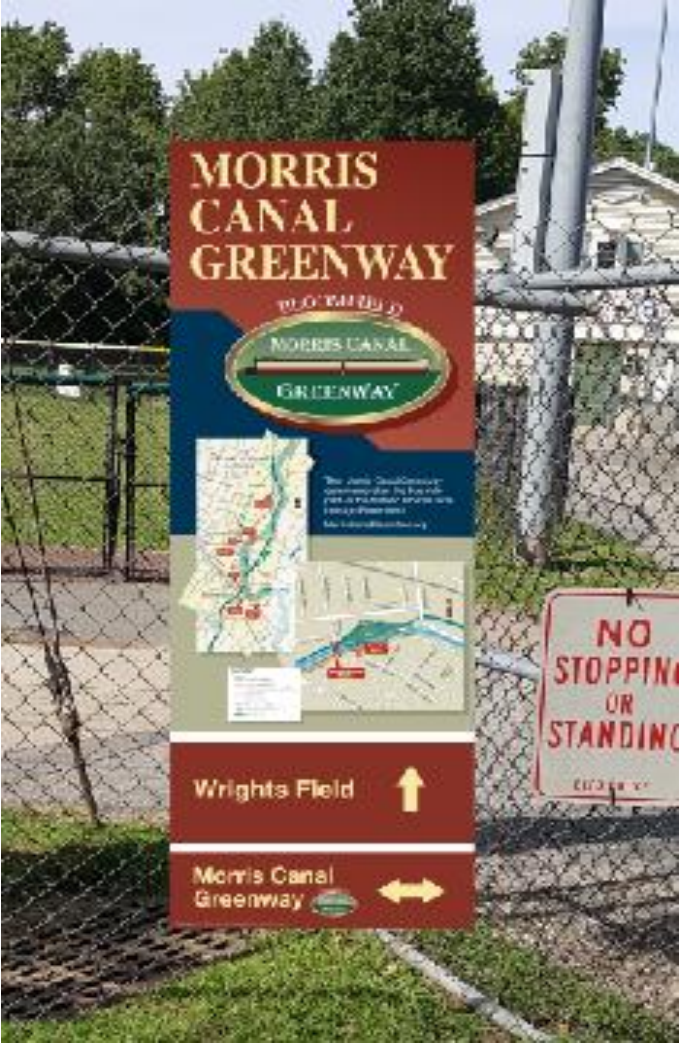

Grants

Awarded:

- NJDEP Recreational Trails Grant Program
- NRPA- Walt Disney Company – Play Spaces Grant

Pending:

- NJ DOT, US DOT Federal Highway Administration—Transportation Alternatives Program 2016 (TAP)
- 2016 NJDEP - Recreation Trails Program Grants

Other Support:

- Township of Bloomfield (funding, labor, services)
- Home Depot (In-Kind, lumber)
- Boy Scouts, Troop 22 Bloomfield (labor, volunteer support)
- Local businesses supplied volunteers/scouts donations of food/materials



Partnership Consideration:

- Council Members
- Town Administrator
- Town Engineer
- Planning Board (Master Plan Inclusion)
- Recreation/Parks Department

- Cub Scouts & Boy Scouts
- Local Morris Canal Greenway Committee
- Open Space & Green Committees
- Park Friends/Conservancy Groups
- Local business
- Business Improvement Organization
- Local schools elementary - college



Acknowledgments

Bloomfield Town Council

Michael Venezia, Mayor
Jenny Mundell, Ward 1
Nick Joanow, Ward 2
Carlos Bernard, Ward 3
Dr. Wartyna Davis, At-Large
Carlos M. Pomares, At-Large
Ted Gamble, At-Large

Bloomfield Township Staff

Matthew Watkins, Township Administrator
Michael Scurman, Director, Recreation
Anthony Nesto, Director, DPW
Paul Lasek, Engineer

Bloomfield Morris Canal Greenway Committee

Rich Rockwell, Chairman
Thomas Heaney
Mimi Michalski
Anthony Nesto
Wayne Riedl
Carlos Pomares, Council Liaison

Bloomfield Board of Recreation

Steve Jenkins, Chairman
John Marek, Vice President
Matt Zichelli, Secretary
Michael Cantelupo
Luis Felix
Barbara Fransisco
Thomas Gamble
Tracey Hann
Anthony Todaro

Brendan Gill, Essex County Board of Chosen Freeholders
Ralph Caputo, Assemblyman, Legislative District 28

